

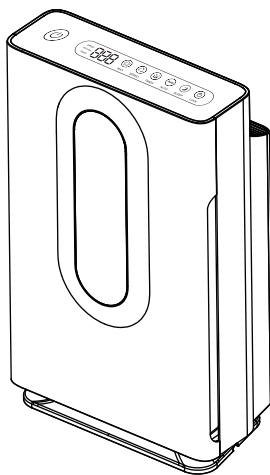

USER MANUAL

EAP500HC



(Image for Reference Only)

Thank you for choosing electriQ

Please read this user manual before using this innovative

Air Purifier and keep it safe for future reference.

Visit our page www.electriQ.co.uk for our entire range of Intelligent Electricals

CONTENTS

1. Safety Instructions	2
2. Air Purifier Features and Indoor Pollutants	4
3. Operation	5
3. How to Use	6
5. Filter Installation	7
6. Diagram of the Air Purifier	7
7. Care and Maintenance	8
8. Technical Specification & Troubleshooting	9

SAFETY INSTRUCTIONS

Important!

- Carefully read the instructions before operating the unit.
- This appliance is for indoor use only.
- This unit must only be connected to a 220V~ / 50Hz earthed outlet.
- Installation must be in accordance with regulations of the country where the unit is used.
- If you are in any doubt about the suitability of your electrical supply, have it checked and, if necessary, modified by a qualified electrician.
- This air purifier has been tested and is safe to use. However, as with any electrical appliance – use it with care.
- Disconnect the air purifier from the socket when changing the filters or cleaning the unit.
- Avoid touching any moving parts of the appliance.
- Never insert fingers, pencils or any other objects through the guard.
- This device is not intended for use by persons (including children) with reduced physical, sensory or mental capabilities. It is also not intended for use by those with a lack of experience and knowledge, unless they have been given supervision or instruction concerning the use of the appliance by a person responsible for their safety.
- Do not leave children unsupervised with this device.
- Do not clean the unit by spraying it or immersing it in water. Use a damp cloth only. Never allow water or vapours to enter the unit.
- Do not clean with strong chemical agents or other abrasive materials.
- Never connect the unit to an electrical outlet using an extension cord. If a power outlet is not available, one should be installed by a qualified electrician.
- Never operate this appliance if the cord or power supply are damaged. Ensure the power cord is not stretched or exposed to sharp objects/edges.
- A damaged power supply should be replaced by the manufacturer. Never extend or attempt to change the power supply lead.
- Any service other than regular cleaning or filter replacement should be performed by an authorised service representative. Failure to comply could result in a voided warranty.
- Do not use the appliance for any other purposes than its intended use.
- Avoid removing the power cord from the socket whilst the unit is still in operation. This could cause electrical damage.
- Never use the power supply as a switch to start and turn off the air purifier unit. Use the provided ON/OFF switch located on the control panel.
- Always place the unit on a dry and stable surface.

- The use of accessory attachments that have not been approved by the appliance manufacturer is not recommended, as this may result in fire, cause an electric shock and/or cause personal injury.
- Ensure hands are fully dried before plugging or unplugging the appliance.
- The appliance should not be installed in laundry or wet rooms.

Energy Saving and Unit Safety Protection Tips

- Do not cover or restrict the airflow from the outlet or inlet grills.
- For maximum performance and safety the minimum distance from a wall or objects should be 20cm. Keep away from other electrical appliances.
- Keep the filters clean. Under normal conditions, filters should only need cleaning once every two weeks (approximately). Since the filters remove airborne particles, more frequent cleaning may be necessary, depending on the air quality.

EAP500HC provides 5 stages of air purification using professional air filtration and intelligent sterilisation technologies.

- Elementary filter, made of non-woven materials, are used for removing large particles like hair and dust.
- Antibacterial HEPA filter to remove 99.9% of airborne particles of 0.25 micrometres or larger.
- Activated carbon filter removes unpleasant odours and absorbs harmful substances such as formaldehydes and benzenes.
- Molecular sieve adsorption layer removes smaller particles.
- Plasma Ioniser sterilises even further and removes mould spores and allergens from the air

Applications:

- Personal use in domestic and office space to improve air quality
- Helps smokers to minimise the effects of smoking
- Helps asthma and pollen sufferers
- Great for children's rooms and small offices

NOTE: This air purifier is not a substitute for proper ventilation, regular vacuum cleaning or for the use of a cooker hood whilst cooking. If the humidity is over 60% Relative Humidity we recommend using a dehumidifier to reduce the humidity.

INFORMATION ON INDOOR POLLUTANTS

VOC (Volatile Organic Compound) – VOCs come from motor vehicle exhausts, gasoline vapour, pollutants such as formaldehyde, ammonia and many other common and chemical solvents such as paints and glues, or can be a by-product of mould growth. VOCs cause irritation to the eyes and or nose as well as causing headaches, nausea and even potential damage to the central nervous system. Pressed wood furniture, newly decorated rooms, paint and cleaning solvents are common sources of VOCs.

Mould / Fungus – these can affect our respiratory system and cause allergic reactions, like a runny nose, eye and throat irritation, headaches, fatigue and aggravation of asthma.

Other indoor pollutants include – bacteria, viruses, dust mites and pollen, etc.

Emissions from electronic office equipment – Many studies, including those from EPA and the University of California Berkley, have reported that emissions from office equipment like, computers and printers, include VOCs, ultra-fine particles and ozone. These emissions have been proven to have a negative effect on the health of many people which can be reduced using an air purifier.

Using HEPA filters, Activated Carbon filters and Plasma Ionisation – An effective HEPA filter is absolutely necessary to remove particles, even at a microscopic level; it ensures that the particles are not spread. Plasma Ionisers will sterilise the air and reduce bacterial growth.

The antibacterial activated carbon on the EAP500HC is a natural material biosynthesized from walnut shell, the adsorption area of activated carbon is very large up to 300,000 square meters. The activated carbon filter will absorb unpleasant odours and reduce the VOC content in the air.

The Plasma Ioniser will sterilise the air and reduce bacterial growth.

OPERATION INSTRUCTIONS

Before first use

1) Unpack the appliance and remove the filter cover:

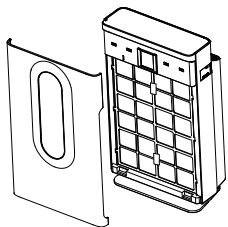

2) Remove the filter and plastic bag:

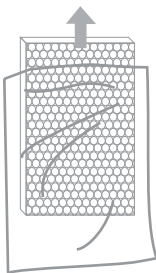

4) Remove the plug adapter and connect it to the socket on the bottom:

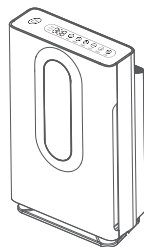

3) Load the composite filter and replace the cover:

5) Connect the plug to an earthed socket:

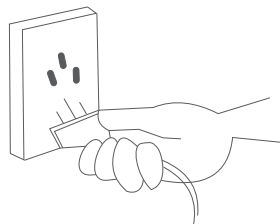
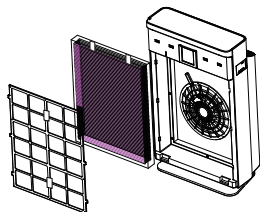

HOW TO USE

How to Use

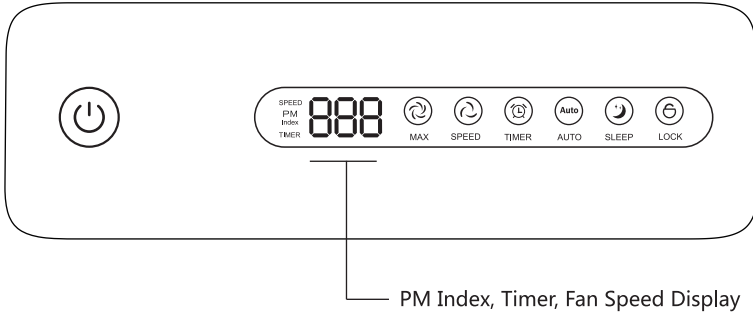

Press the **ON/OFF** button to turn the unit on. Press again to turn off.

With the unit powered on, press the **TIMER** button to select the automatic off time. Press repeatedly to select 1, 2, 3, 4, 5, 6, 7, 8, 9, 10, 11, 12 or 0 hours.

Alter the fan speed by pressing the **SPEED** button. Select from 4 speeds.

Press the **MAX** button to boost the speed to max for 60 mins.

Press the **AUTO** button to select the automatic running mode

Press the **SLEEP** button to select the sleep mode. The lights will be turned off and the fan speed set to low.

Press and hold the **LOCK** button for 5 seconds to disable the other buttons. Press and hold it again for 5 seconds to unlock the buttons.

Press and hold the **AUTO + TIMER** buttons for 3 seconds to reset the filter after it has been replaced.

AIR QUALITY INDICATOR (PM2.5 SENSOR) – After initial power on the unit will take 90 seconds to warm up before showing the PM2.5 value. Once the unit is warmed up the PM2.5 indicator will refresh every 5 seconds. The LED will indicate the air quality as follows:

Green – Excellent – $0-50\mu\text{g}/\text{m}^3$

Blue – Good – $50-100\mu\text{g}/\text{m}^3$

Yellow – Medium – $101-150\mu\text{g}/\text{m}^3$

Red – Bad – $151+\mu\text{g}/\text{m}^3$

FILTER INSTALLATION

Changing the Filter

Open the filter cover by pressing in the retaining tabs and pulling the cover free. Remove the old filters by simply pulling on the tabs to release them. Replace the filters with new/clean ones and replace the filter cover.

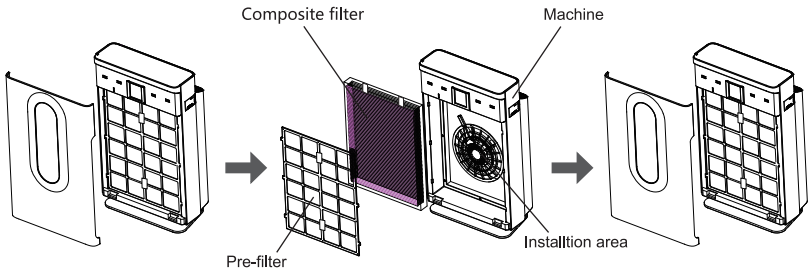
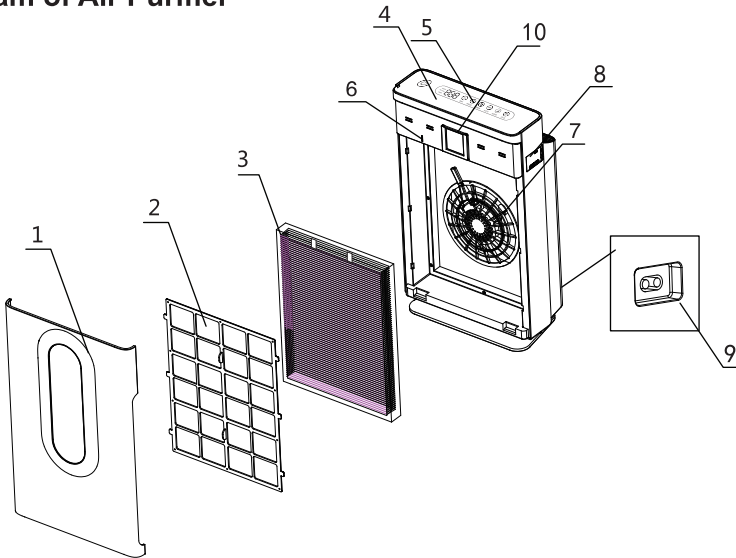

Diagram of Air Purifier



- 1. Front Panel
- 2. Pre-filter
- 3. Composite Filter
- 4. Display Panel
- 5. Touch Keys
- 6. Front Panel Switch
- 7. Motor & Fan
- 8. Sensor
- 9. Plug Input
- 10. Air Quality Indication Lamp

CARE AND MAINTENANCE

Care and Maintenance

- Always shut off the unit and unplug from the mains before cleaning or performing any maintenance.
- When the unit is not in use for long periods, it is advisable to remove the plug from the power socket.
- Do not use chemical solvents (such as benzene, alcohol or gasoline) as they may cause irreversible damage to the unit.

Cleaning the Case

- Only use tepid water and a mild detergent on a soft cloth.
- Do not use bleach or abrasives.
- Do not splash water directly onto the main unit.
- Avoid wetting the power connection port, doing so may cause an electric shock and can lead to the insulation deteriorating or unit to rust.

Cleaning the Filters and Filter Holding Area

- Hoover the filter gently every 2-3 weeks or more often if used in a dustier environment.
- Make sure the filter is not damaged during the process and replace if it does become damaged.
- Wipe the filter holding area with a dry cloth if necessary.

Clean the filter Cover and Clean Air Outlet

- Use water and a mild detergent.
- Do not use bleach or abrasives.
- Do not spray water inside the unit.
- If the clean air outlet grilles get soiled easily, use a vacuum attachment or soft brush to clean.
- If the filter cover is dirty, Hoover it. If it is heavily soiled, wash it with warm soapy water and dry thoroughly before reinserting it in the unit.

NOTE: Do not assemble the unit and power it on before all the parts are completely dry. Any other maintenance than what is described in this user manual must be only performed by the service centre.

TECHNICAL SPECIFICATION & TROUBLESHOOTING

Technical Specification

Input power	220~240V AC 50Hz
Weight	9.5Kg
Dimensions	420 x 240 x 690mm
Fan speeds	Low / Medium / High / Turbo
Noise	≤66dB
Ions	10 million / cm ³
Formaldehyde purification rate	160m ³ /h

Troubleshooting

Issue	Check
Not working	Check that the power cord is connected and is the correct rating.
Abnormal Smells	Check if the filters clean. Replace filters.
Pollutants not removed and loud noise when running	Check if the filters clean. Replace filters.

Disposal



Disposal: Do not dispose this product as unsorted waste. Collection of such waste must be handled separately as special treatment is necessary.

Recycling facilities are now available for all customers at which you can deposit your old electrical products. Customers will be able to take any old electrical equipment to participating sites run by their local councils. Please remember that this equipment will be further handled during the recycling process, so please be considerate when depositing your equipment. Please contact the local council for details of your local household waste recycling centres.

ElectrIQ UK SUPPORT

www.ElectrIQ.co.uk/support

Please, for your own convenience, check the troubleshooting guide before calling the service line.

**If the unit still fails to operate call: 0871 620 1057 or
complete the online form**

Office hours: 9AM - 5PM Monday to Friday

www.ElectrIQ.co.uk

Unit 2, The Nursery

Berristow Lane

South Normanton

Derbyshire, DE55 2FX